

Remote Actuator



Service Instructions

DISASSEMBLY

1. Disconnect necessary fluid lines. Drain fluid from the actuator and remove from machine.
2. Remove end plug (1), piston assembly (2), spring (3), and end plug (5) from housing (4).
3. Remove retainer (12), and seat (13) from end plug (5).
4. Remove o-rings (6) from end plugs (1 & 5).
5. Remove retaining ring (11), stem (10), spring (9), and cups (7) from piston (8). Note direction of cups (7).
6. Remove bleeder screws (14 & 15) from housing (4).

ASSEMBLY

LUBRICATE ALL COMPONENTS FROM REPAIR KIT WITH CLEAN TYPE FLUID USED IN THE SYSTEM.

1. Thoroughly clean housing bore and all parts in clean system fluid.
2. Install new o-ring (6), new seat (13), and new retainer (12) on end plug (5). Torque retainer (12) 10.9-16.3 N·m (8-12 lb-ft).
3. Install new o-ring (6) on end plug (1).
4. Install spring (9), stem (10), and retaining ring (11) in piston (8).

5. Install new cups (7) on piston (8). Note direction of cups (7).
6. Install piston assembly (2) and spring (3) in housing (4).
NOTE: To avoid damage to cups (7), piston assembly (2) must be installed in the housing (4) end shown in Figure 1.
7. Install end plug (1) and torque 61.0-81.4 N·m (45-60 lb-ft).
8. Install end plug (5) in housing (4) and torque 61.0-81.4 N·m (45-60 lb-ft).
9. Install new bleeder screw (14) in housing (4) and torque 4.5-5.7 N·m (40-50 lb-in).
10. Install new bleeder screw (15) in housing (4) and torque bleeder screw (15) 1.7-2.8 N·m (15-25 lb-in).
11. Install actuator on machine. Connect fluid lines. Bleed system of air. Torque bleeder screw (14) 4.5-5.7 N·m (40-50 lb-in). Torque bleeder screw (15) 1.7-2.8 N·m (15-25 lb-in). Tighten fittings if leaks occur. Make several applications to be sure actuator is working properly. **NOTE: All fittings must be inspected for leaks and tightened if leaks occur.**

⚠ CAUTION

During the bleeding process, hydraulic pressure should not exceed 13.8 bar (200 PSI).

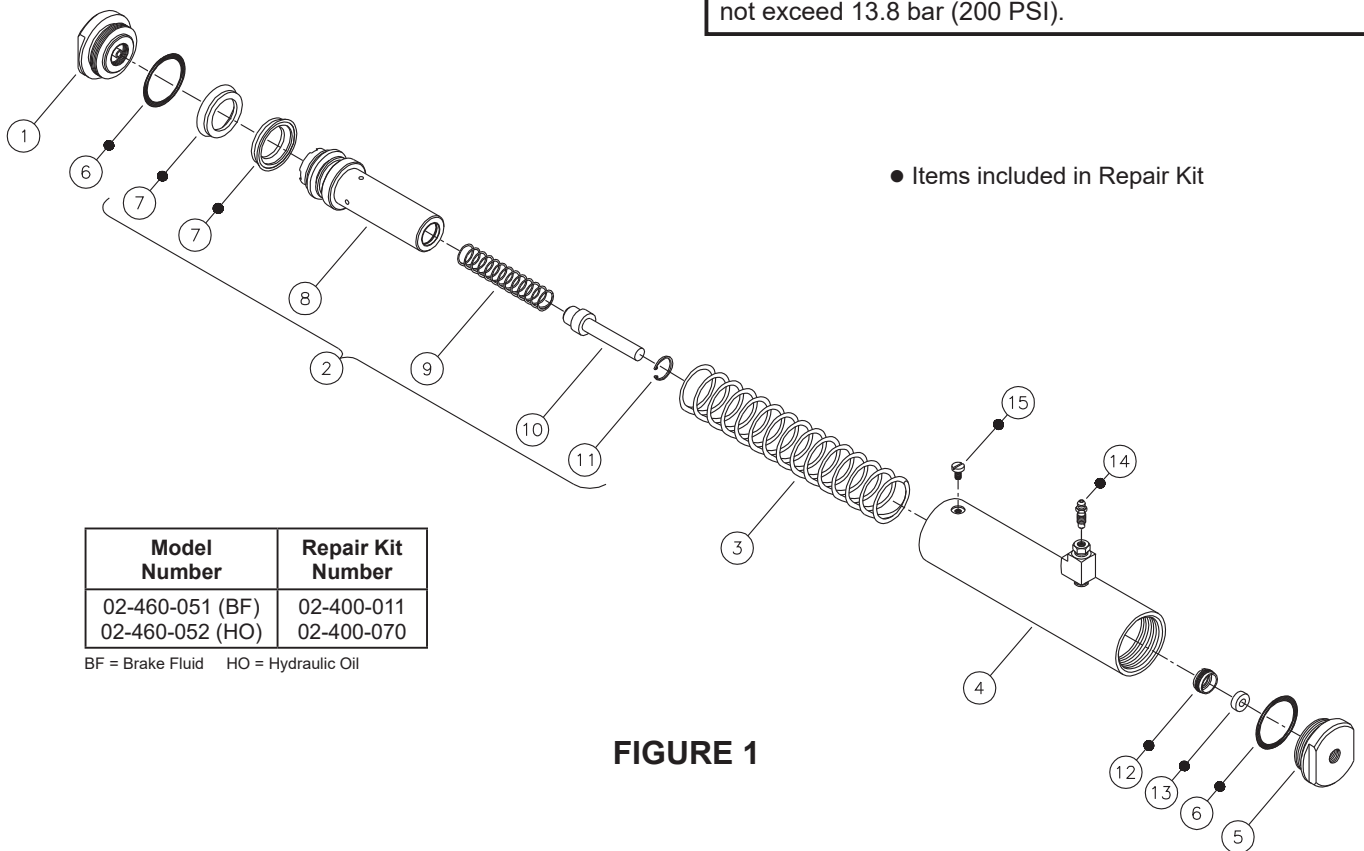

Model Number	Repair Kit Number
02-460-051 (BF)	02-400-011
02-460-052 (HO)	02-400-070

BF = Brake Fluid HO = Hydraulic Oil

FIGURE 1

This publication is not subject to any update service. Information contained in this publication was in effect at the time the publication was approved for printing and is subject to change without notice or liability. ZF Off-Highway Solutions Minnesota Inc. reserves the right to revise the information presented or to discontinue the production of parts described at any time.

