

RELAY VALVE



Service Instructions

DISASSEMBLY

NOTE

Housing halves (5 & 11) and spools (6 & 12) are manufactured as matched sets. These sets (housing and spool) must not be intermixed with other parts.

1. Disconnect necessary fluid lines. Remove valve from vehicle and drain fluid before disassembling.
2. Separate housings (5 & 11) by removing two cap screws (4).
3. Remove o-ring (8) and spacer (7) from housing (11).
4. Remove end plug (1) from housing (5). Remove o-rings (2 & 3) from end plug (1).
5. Using a wooden dowel remove spool (6) from housing (5). **NOTE: Be careful not to damage spool or housing bore.**
6. Remove end plug (15) and spring (13) from housing (11). Remove o-ring (14) from end plug (15).
7. Using a wooden dowel remove spool (12) from housing (11). **NOTE: Be careful not to damage spool or housing bore.**
8. Remove plugs (9) from housing (11). Remove o-rings (10) from plugs (9).

ASSEMBLY

LUBRICATE SPOOLS (6 & 12) AND ALL RUBBER COMPONENTS FROM REPAIR KIT WITH CLEAN TYPE FLUID USED IN THE SYSTEM.

1. Clean all parts thoroughly before assembling.
2. Install spacer (7) and o-ring (8) on housing (11).
3. Attach housings (5 & 11) using two cap screws (4). Torque cap screws 29.8-33.9 N·m (22-25 lb·ft).
4. Install new o-ring (14) on end plug (15).
5. Install spool (12), spring (13) and end plug (15) in housing (11). Torque end plug 47.5-54.2 N·m (35-40 lb·ft). Note direction of spool (12). **NOTE: Spool must slide freely into bore. If either part is damaged, a new spool/housing assembly may be required.**
6. Install new o-rings (2 & 3) on end plug (1).
7. Install spool (6) and end plug (1) in housing. Torque end plug 54.2-61.0 N·m (40-45 lb·ft). Note direction of spool (6). **NOTE: Spool must slide freely into bore. If either part is damaged, a new spool/housing assembly may be required.**
8. Install new o-rings (10) on plugs (9). Install plugs (9) in housing and torque 13.6-19.0 N·m (10-14 lb·ft).
9. Install valve on vehicle. Connect necessary fluid lines. Bleed system of air. Tighten fittings if leaks occur. Make several applications to be sure valve is working properly. **NOTE: All fittings must be inspected for leaks and tightened if leaks occur.**

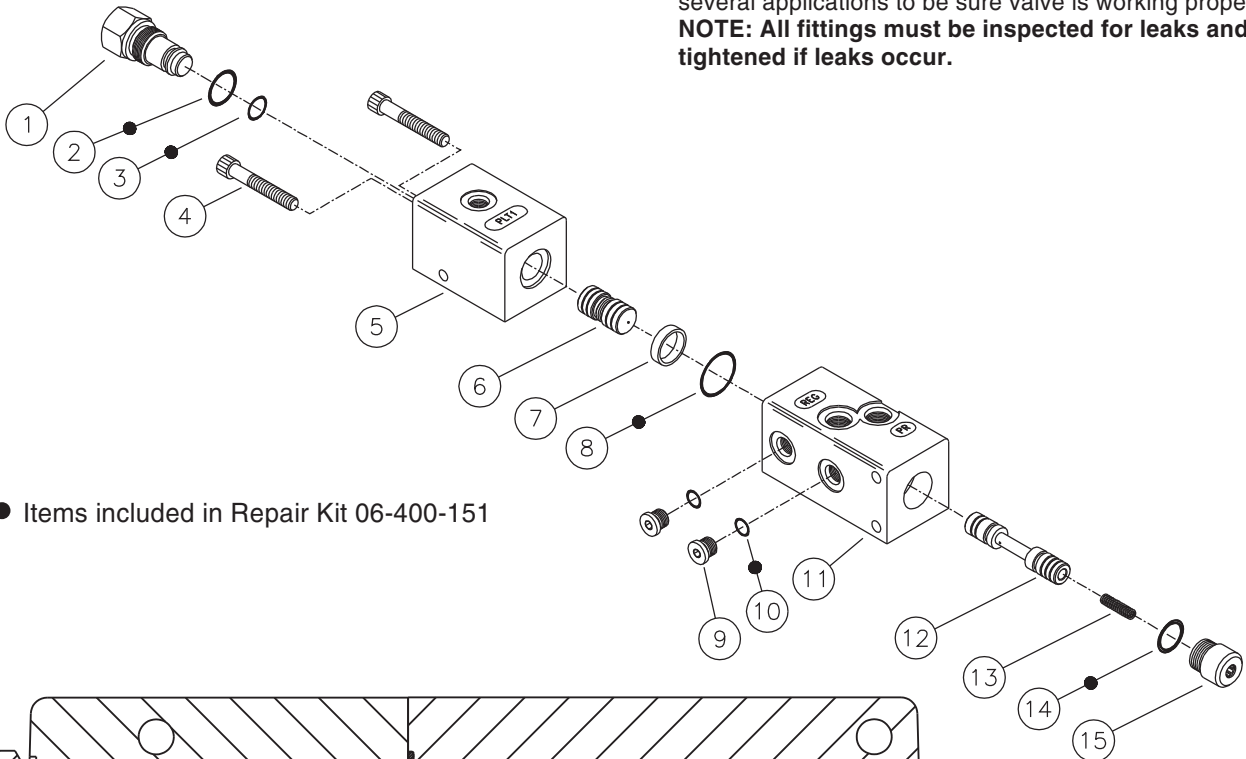

● Items included in Repair Kit 06-400-151

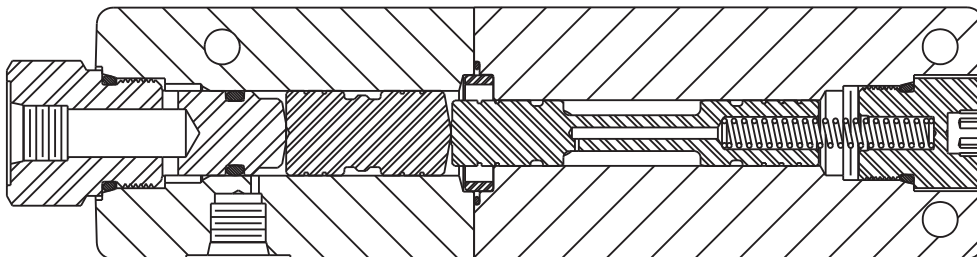

This publication is not subject to any update service. Information contained in this publication was in effect at the time the publication was approved for printing and is subject to change without notice or liability. ZF Off-Highway Solutions Minnesota Inc. reserves the right to revise the information presented or to discontinue the production of parts described at any time.

